

### MAIN FEATURES

Standard  $\varnothing$  63 mm encoder series for industrial applications with high mechanical resistance requirements. These encoders are designed to support high radial and axial shaft load and they can be mounted by means of flanges or fixing clamps.

- 3 channel encoder (A / B / Z) up to 10000 ppr based on innovative magnetic ASIC
- Power supply up to +30 V DC with several electrical interfaces available
- Up to 800 kHz output frequency
- Cable or connector output
- Available with metal cover for heavy duty applications
- Solid shaft diameter up to 10 mm
- Mounting by synchronous or centering 2,5" square flange



ORDERING CODE	EMI	63A	M*	500	S	5/30	P	8	X	X	M	R	.162	+XXX
---------------	-----	-----	----	-----	---	------	---	---	---	---	---	---	------	------

magnetic incremental encoder series	<b>SERIES</b>														
	<b>MODEL</b>														
		synchronous flange $\varnothing$ 31,75 mm	63A												
		centering square flange $\varnothing$ 31,75 mm	63D												
		centering square flange $\varnothing$ 50 mm	63E												
		<b>METAL COVER</b>													
		* add for metal cover	M												
		<b>RESOLUTION</b>													
		ppr from 1 to 10000													
		please refer to the preferred resolutions list													
		<b>ZERO PULSE</b>													
		without zero pulse	S												
		with zero pulse	Z												
		<b>POWER SUPPLY</b>													
		(with L electrical interface) 5 V DC	5												
	5 ... 30 V DC	5/30													
	<b>ELECTRICAL INTERFACE</b>														
	NPN open collector	C													
	push-pull	P													
	line driver	L													
	power supply 5/30 V DC - output RS-422	RS													
	<b>SHAFT DIAMETER</b>														
	mm	8													
	(3/8")	9,52													
	mm	10													
	<b>ENCLOSURE RATING</b>														
	IP 54	X													
	IP 66	S													
	<b>OPTION</b>														
	to be reported	X													
	<b>OUTPUT TYPE</b>														
	cable (standard length 1,5 m)	P													
	preferred cable lengths 2 / 3 / 5 / 10 m, to be added after DIRECTION TYPE (eg. PR5)														
	MIL plug connector	M													
	JIS-C-5432 plug connector	J													
	M12 plug connector	M12													
	M23 plug connector	H													
	M16 plug connector	C													
	<b>DIRECTION TYPE</b>														
	axial	A													
	radial	R													
	<b>SOCKET</b>														
	socket not included	.162													
	to be reported only with connector output (eg. MR.162), for socket see Accessories														
	<b>VARIANT</b>														
	custom version	+XXX													

63A

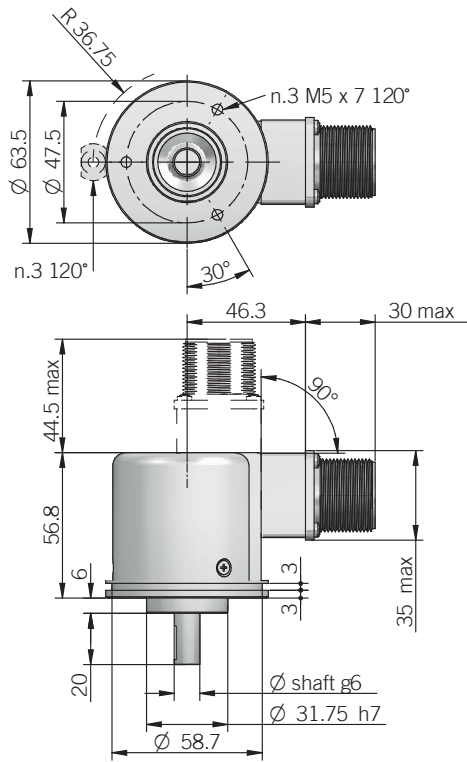

fixing clamps not included, please refer to the Accessories

63D

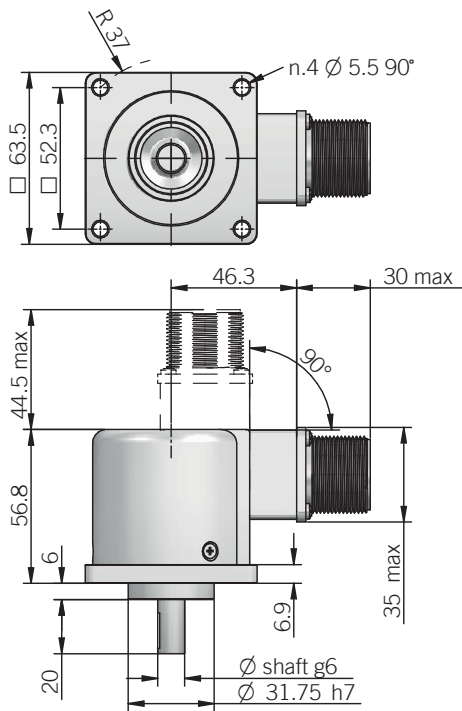

DIMENSION WITH METAL COVER AND AXIAL OUTPUT

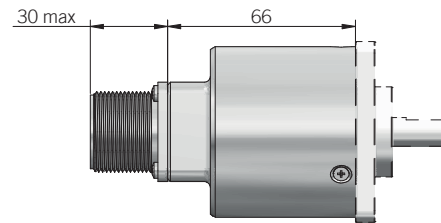

DIMENSION WITH METAL COVER AND RADIAL OUTPUT

63 E

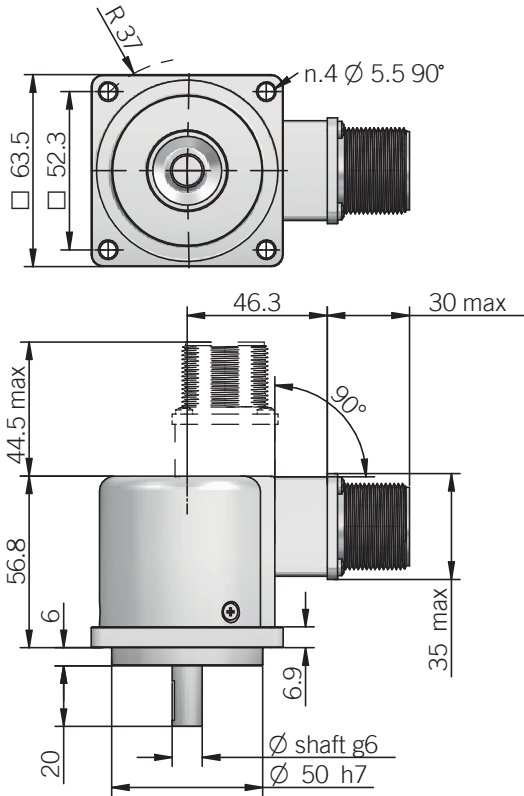

recommended mating shaft tolerance H7  
dimensions in mm

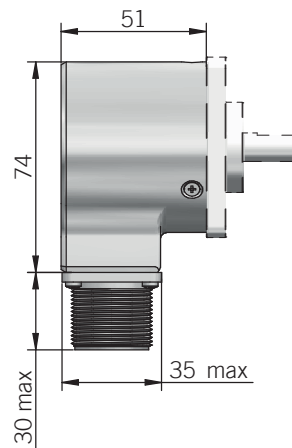

**ELECTRICAL SPECIFICATIONS**

<b>Resolution</b>	from 1 to 10000 ppr
<b>Power supply<sup>1</sup></b>	5 = 4,5 ... 5,5 V DC 5/30 = 4,5 ... 30 V DC (reverse polarity protection)
<b>Power draw without load typical</b>	0,4 W
<b>Max load current</b>	C / P = 50 mA / channel L / RS = 20 mA / channel
<b>Electrical interface<sup>2</sup></b>	NPN open collector (AEIC-7273, pull-up max +30 V DC) push-pull / line driver HTL (AEIC-7272 or similar) line driver RS-422 (AELT-5000 or similar)
<b>Max output frequency</b>	800 kHz
<b>Counting direction</b>	A leads B clockwise (shaft view)
<b>Index signal</b>	180°e (gated A)
<b>Startup time typical</b>	10 ms
<b>Accuracy</b>	< 0,3° at +20°C (+68°F) ± 0,5° in the operating temperature range
<b>Hysteresis</b>	0,70° up to 256 ppr 0,35° from 257 ppr to 10000 ppr
<b>Mean time to dangerous failure (MTTF)<sub>d</sub><sup>3</sup> according to EN ISO 13849-1</b>	275 years
<b>Mission time (Tm)<sup>3</sup></b>	20 years
<b>Diagnostic coverage (DC)<sup>3</sup></b>	0%
<b>Cable type</b>	shielded - fixed installation conductors section 0,22 mm <sup>2</sup> / AWG 24 bending radius min 60 mm
<b>Electromagnetic compatibility</b>	according to 2014/30/EU directive
<b>RoHS</b>	according to 2011/65/EU directive
<b>UL / CSA</b>	file n. E212495

**MECHANICAL SPECIFICATIONS**

<b>Shaft diameter</b>	ø 8 / 9,52 (3/8") / 10 mm
<b>Enclosure rating IEC 60529</b>	X = IP 54 S = IP 66
<b>Max rotation speed</b>	6000 rpm
<b>Max shaft load<sup>4</sup></b>	200 N (45 lbs) axial / radial
<b>Shock</b>	50 G, 11 ms (IEC 60068-2-27)
<b>Vibration</b>	10 G, 10 ... 2000 Hz (IEC 60068-2-6)
<b>Moment of inertia</b>	1,5 x 10 <sup>-6</sup> kgm <sup>2</sup> (36 x 10 <sup>-6</sup> lbf <sup>2</sup> )
<b>Starting torque (at +20°C / +68°F)</b>	< 0,02 Nm (2,83 Ozin) with X enclosure rating < 0,06 Nm (8,50 Ozin) with S enclosure rating
<b>Bearing stage material</b>	aluminum
<b>Shaft material</b>	stainless steel
<b>Housing material</b>	PA66 glass fiber reinforced / painted aluminum
<b>Bearings</b>	n.2 ball bearings
<b>Bearings life</b>	10 <sup>9</sup> revolutions
<b>Operating temperature<sup>5, 6</sup></b>	-25° ... +100°C (-13° ... +212°F) -25° ... +85°C (-13° ... +185°F) with M12 connector
<b>Storage temperature<sup>6</sup></b>	-25° ... +70°C (-13° ... +158°F)
<b>Weight</b>	350 g (12,35 oz) 450 g (15,87 oz) with metal cover

<sup>1</sup> as measured at the transducer without cable influences  
<sup>2</sup> for further details refer to OUTPUT LEVELS on TECHNICAL BASICS section  
<sup>3</sup> this product is not a safety component, for further details refer to TECHNICAL BASICS section  
<sup>4</sup> maximum load for static usage  
<sup>5</sup> measured on the transducer flange  
<sup>6</sup> condensation not allowed

**PREFERRED RESOLUTIONS**

2 - 4 - 5 - 6 - 8 - 10 - 12 - 16 - 20 - 30 - 40 - 50 - 60 - 80 - 90 - 100 - 125 - 128 - 200 - 250 - 256 - 360 - 400 - 500 - 512 - 720 - 1000 - 1024 - 1440 - 2000 - 2048 - 3600 - 4096 - 5000 - 7200 - 10000

please directly contact our offices for other pulses

**CONNECTIONS**

Function	Cable C / P	Cable L / RS	7 pin J C / P	7 pin J L / RS no Zero	7 pin M C / P	7 pin M L / RS no Zero	10 pin J L / RS with Zero	10 pin M L / RS with Zero	5 pin M12 C / P	8 pin M12 L / RS	12 pin H	5 pin C C / P	8 pin C L / RS
+V DC	red	red	6	4	F	D	4 - 5	D - E	2	7	12	5	7
0 V	black	black	1	6	A	F	6	F	4	1	10	1	8
A+	green	green	3	1	C	A	1	A	3	6	5	2	1
A-	/	brown or grey	/	3	/	C	7	G	/	5	6	/	2
B+	yellow	yellow	5	2	E	B	2	B	1	4	8	4	3
B-	/	orange	/	5	/	E	8	H	/	3	1	/	4
Z+	blue	blue	4	/	D	/	3	C	5	2	3	3	5
Z-	/	white	/	/	/	/	9	I	/	8	4	/	6
≡	shield	shield	7	7	G	G	10	J	housing <sup>1</sup>	housing <sup>1</sup>	9	housing <sup>1</sup>	housing <sup>1</sup>

